



12 Orchard Crescent
, Stevenage, SG1 3EW
Guide price £475,000



2



1



2



12 Orchard Crescent

, Stevenage, SG1 3EW

Guide Price £475,000 to £500,000.

Located in Stevenage Old Town is this two/ three bedroom, semi-detached property with off road parking and a garage.

Step inside an entrance porch which leads through to a bright and welcoming hallway. To the right is a generously sized lounge/ dining room, featuring dual-aspect views to the front and rear, and a central electric fire with surround. Continuing through the lounge is a conservatory, offering space for a seating area the perfect spot to enjoy the west-facing garden.

Across the entrance hall is an additional reception room, ideal as a bedroom or dining area for hosting family and friends. The kitchen is a contemporary space, finished with white gloss cabinets, black worktops, and stylish feature tiling. A breakfast bar provides a great option for informal dining and offers lovely views out to the garden. Completing the ground floor is a convenient W/C.

Upstairs, there are two double bedrooms. Bedroom one is a bright and airy room with dual-aspect windows to the front and side. Mirrored built-in wardrobes offer ample storage space. Bedroom two also benefits from built-in wardrobes and a useful cupboard over the stairs. The modern three-piece bathroom includes a bath with shower over and a vanity sink unit, ideal for storing toiletries and cleaning products.

Outside, the west-facing garden features





a large patio area suitable for garden furniture, a neat lawn with shrub borders, a shed for storage, and a greenhouse area for growing your own flowers or produce. Access to the front of the property is via a side gate, leading to the garage and driveway. To the front, there is an additional garden area with shingle borders, shrubs, and off-street parking for up to three cars.

What's in the area

Floor Plan

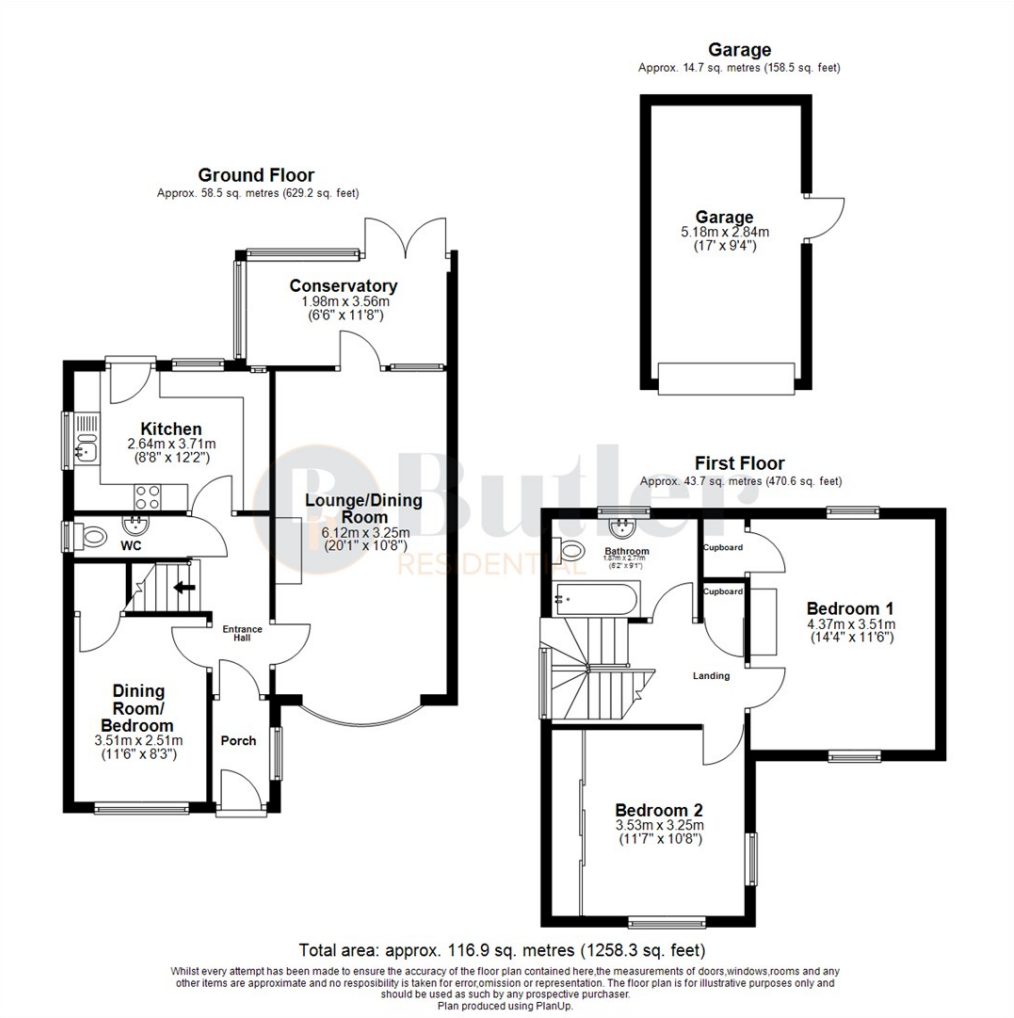

Viewing

Please contact us on 01438 584400 if you wish to arrange a viewing appointment for this property or require further information.

These particulars, whilst believed to be accurate are set out as a general outline only for guidance and do not constitute any part of an offer or contract. Intending purchasers should not rely on them as statements of representation of fact, but must satisfy themselves by inspection or otherwise as to their accuracy. No person in this firms employment has the authority to make or give any representation or warranty in respect of the property.

Area Map

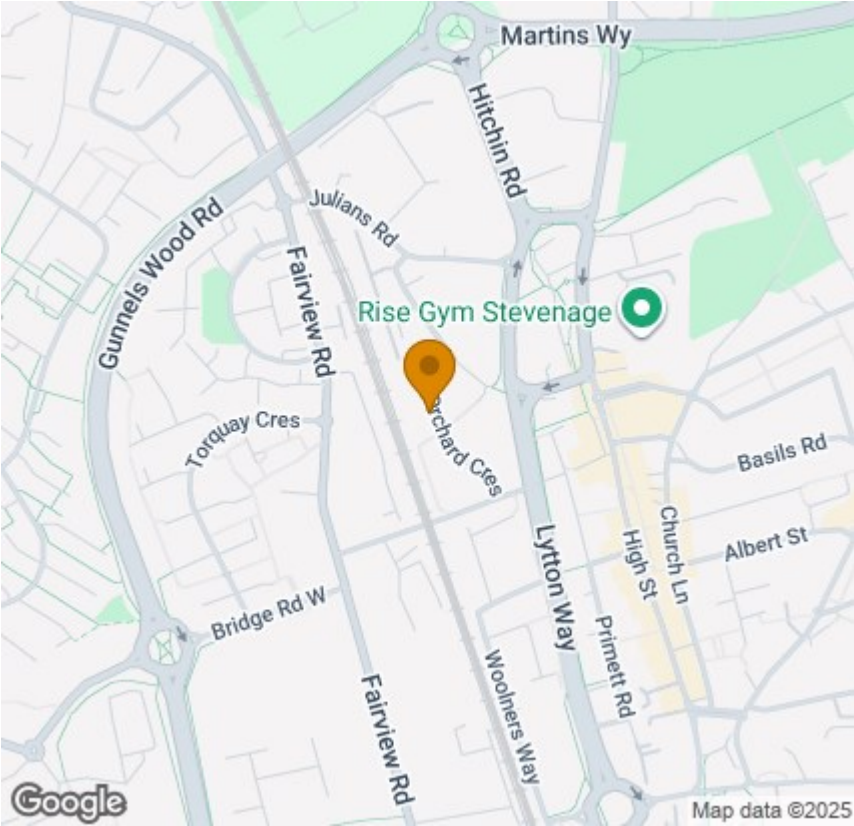

Energy Efficiency Graph

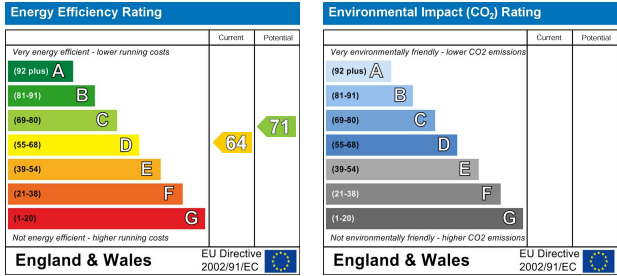

Address: Suite 2, First Floor, Unit B, Balbir House Norton Green Road, Stevenage, SG1 2LP
Tel: 01438 584400
Email: hello@butlerresidential.co.uk



butlerresidential.co.uk